

HANDWHEEL WITH RISING STEM

The definition variables are as follows:

B = Max. width of the valve (without actuator).

P = Max. height of the valve (without actuator).

OPTIONS:

- Locking devices.
- Extensions: stand, pipe, plates.
- DN higher than those give in the table.

ACTUATOR INCLUDING:

- Handwheel
- Steam
- Nut
- Stem protection hood

AVAILAIBLE:

- Santdard ND50 a ND1000.
- Other ND on request.

- From ND350 (included) the actuator is with geared motor.
- Other pressures on request (ΔP)

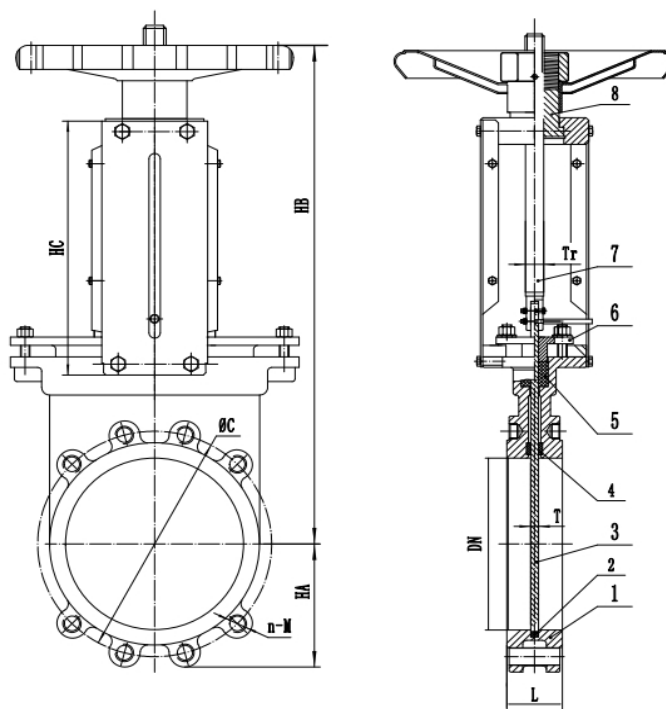

ND	ΔP (bar)	A	B	C	P	D	HV	ϕV	Kg.	r (B.S.P.)
50	10	54	109	106	280	319	451	225	12	1/4"
65	10	54	109	113	306	345	502	225	14	1/4"
80	10	57	109	122	332	372	553	225	18	1/4"
100	10	57	109	136	368	407	589	225	21	1/4"
125	10	64	126	153	421	474	675	325	26	1/4"
150	10	64	126	168	466	519	759	325	33	1/4"
200	10	76	126	199	565	618	958	325	52	3/8"
250	10	76	197	234	626	750	1127	450	74	1/2"
300	10	83	197	272	739	838	1230	450	98	1/2"
350	10	83	350	297	842	--	--	--	--	1/2"
400	10	96	350	330	933	--	--	--	--	3/4"
450	10	96	350	355	1019	--	--	--	--	3/4"
500	10	121	380	391	1156	--	--	--	--	3/4"
600	10	121	400	461	1338	--	--	--	--	1"
700	6	182	400	534	1425	--	--	--	--	1"
750	6	188	400	559	1520	--	--	--	--	1"
800	6	206	400	584	1615	--	--	--	--	1"
900	6	225	400	649	1823	--	--	--	--	1"
1000	4	240	440	699	1992	--	--	--	--	1"

GEAR BOX

It is recommendable for DN greater than 350

The definition variables are as follows:

B = Max. width of the valve (without actuator).

P = Max. height of the valve (without actuator).

OPTIONS:

- Chainwheel.
- Locking devices.
- Extensions: stand, pipe, plates...
- Non.rising stem.

ACTUATOR INCLUDING:

- Stem
- Yoke
- Handwhell
- Cone-shaped gear box

Standard ratio = 4 to 1

AVAILABLE:

- ND50 a ND1500, otros ND bajo consulta.
- other ND on request.
- Other pressures on request

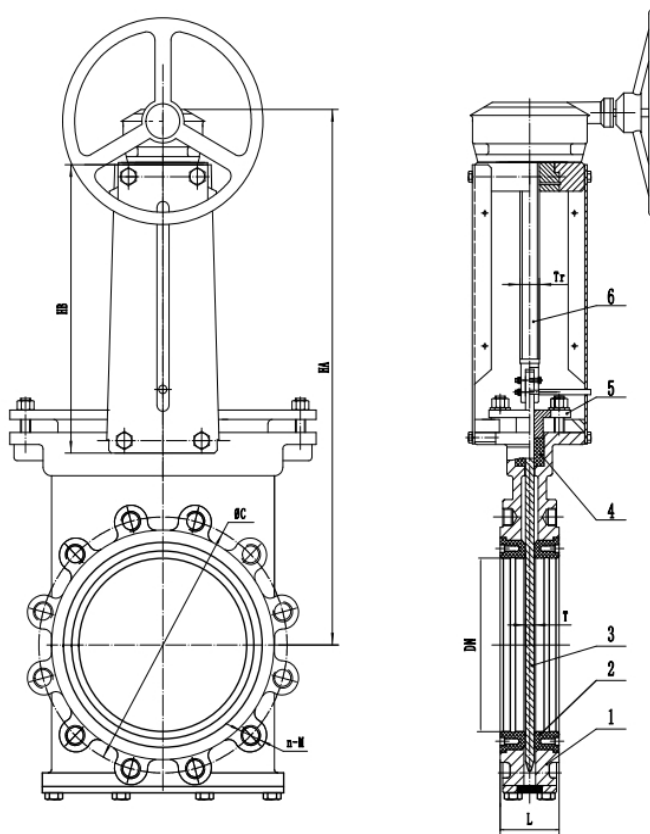

ND	ΔP (bar)	A	B	C	P	D	Hr	r (B.S.P.)
50	10	54	109	106	280	402	581	1/4"
65	10	54	109	113	306	446	621	1/4"
80	10	57	109	122	332	454	633	1/4"
100	10	57	109	136	368	490	669	1/4"
125	10	64	126	153	421	565	800	1/4"
150	10	64	126	168	466	589	848	1/4"
200	10	76	126	199	565	689	948	3/8"
250	10	76	197	234	626	735	1119	1/2"
300	10	83	197	272	739	833	1217	1/2"
350	10	83	350	297	842	935	1384	1/2"
400	10	96	350	330	933	1028	1627	3/4"
450	10	96	350	355	1019	1120	1719	3/4"
500	10	121	380	391	1156	1275	1889	3/4"
600	10	121	400	461	1338	1457	2171	1"
700	6	182	400	534	1530	1764	2440	1"
750	6	188	400	559	1637	1860	2555	1"
800	6	206	400	584	1733	1950	2807	1"
900	6	225	400	649	1954	2090	3148	1"
1000	4	240	440	699	2160	2233	3579	1"
1100	4	240	440	730	2310	2446	3779	1 1/2"
1200	4	254	480	775	2551	2522	3807	1 1/2"

DOUBLE-ACTING PNEUMATIC CYLINDER

The definition variables are as follows:

B = Max. width of the valve (without actuator).

P = Max. height of the valve (without actuator).

AVAILABLE:

- ND50 a ND700, otros ND bajo consulta.
- Other ND on request.

The air supply pressure to the cylinder is a minimum of 6 bar and a maximum of 10 bar, the air must be dry and lubricated.

For ND50 to ND200 valves, the cylinder's jacket and covers are made of aluminium, the rod of AISI304, the piston of rubber-coated steel and the O-ring seals are made of nitrile.

For pneumatic cylinders larger than Ø200 the covers are made of nodular cast iron or carbon steel.

On request, we can also supply the actuator made entirely of stainless steel, especially for installation in corrosive atmospheres.

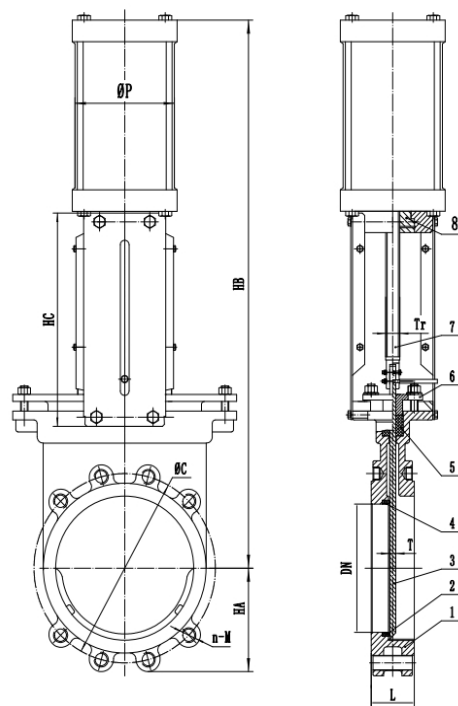

ND	ΔP (bar)	A	B	C	P	Hn	J	Ø CIL	ØVAST	s (B.S.P.)	Weight (Kg)	r (B.S.P.)
50	10	54	109	106	280	475	96	80	20	1/4"	12	1/4"
65	10	54	109	113	306	515	96	80	20	1/4"	14	1/4"
80	10	57	109	122	332	555	115	100	20	1/4"	18	1/4"
100	10	57	109	136	368	620	138	125	25	1/4"	23	1/4"
125	10	64	126	153	421	700	175	160	30	1/4"	28	1/4"
150	10	64	126	168	466	775	175	160	30	1/4"	38	1/4"
200	10	76	126	199	565	940	218	200	30	3/8"	61	3/8"
250	10	76	197	234	626	1140	270	250	40	3/8"	123	1/2"
300	10	83	197	272	739	1300	382	300	45	1/2"	174	1/2"
350	10	83	350	297	842	1485	444	350	45	1/2"	211	1/2"
400	10	96	350	330	933	1655	508	400	50	1/2"	278	3/4"
450	10	96	350	355	1019	1805	552	450	50	3/4"	368	3/4"
500	10	121	380	391	1156	2000	612	500	50	3/4"	429	3/4"
600	10	121	400	461	1338	2285	772	585	60	1"	503	1"
700	6	182	400	534	1530	2495	772	635	60	1"	--	1"

ELECTRIC ACTUATOR

This actuator is automatic and includes the following parts:

- Electric motor.
- Stem
- Yoke

OPTIONS:

- Different types and brands.
- Non-rising stem.
- ISO 5210 / DIN 3338 Flanges
- Available: ND50 to ND1400
- O other ND on request.
- From ND350 (inclusive) the motor is assisted with a gear box.
- Other pressures on request (ΔP).

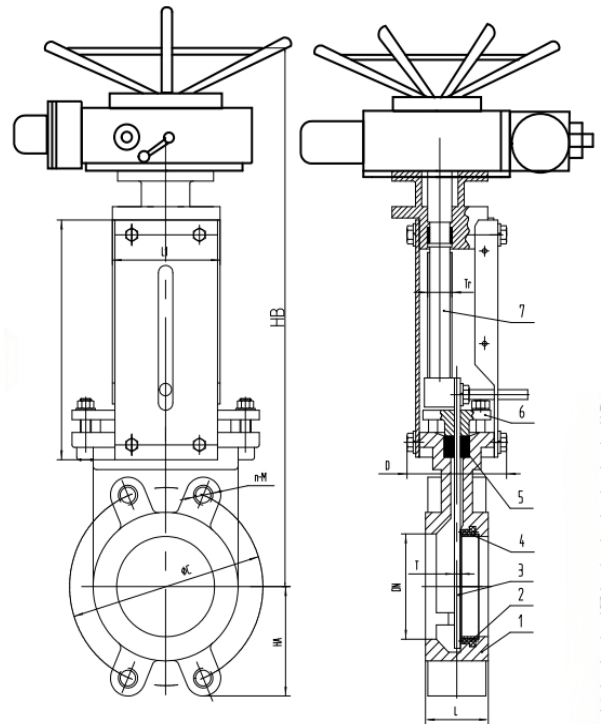

ND	ΔP (bar)	A	B	C	P	K	L	M	N	O	He	r (B.S.P.)
50	10	54	109	106	280	249	265	238	62	436	631	1/4"
65	10	54	109	113	306	249	265	238	62	462	657	1/4"
80	10	57	109	122	332	249	265	238	62	488	683	1/4"
100	10	57	109	136	368	249	265	238	62	524	719	1/4"
125	10	64	126	153	421	249	265	238	62	574	769	1/4"
150	10	64	126	168	466	249	265	238	62	624	819	1/4"
200	10	76	126	199	565	249	265	238	62	723	1033	3/8"
250	10	76	197	234	626	254	283	248	65	781	1121	1/2"
300	10	83	197	272	739	254	283	248	65	879	1219	1/2"
350	10	83	350	297	842	249	265	407	82	975	1384	1/2"
400	10	96	350	330	933	254	283	424	82	1078	1627	3/4"
450	10	96	350	355	1019	254	283	424	82	1170	1719	3/4"
500	10	121	380	391	1156	336	389	479	103	1338	1889	3/4"
600	10	121	400	461	1338	336	389	479	103	1520	2171	1"
700	6	182	400	534	1530	336	389	479	103	1831	2440	1"
750	6	188	400	559	1637	336	389	479	103	1927	2555	1"
800	6	206	400	584	1733	339	389	528	136	2017	2807	1"
900	6	225	400	649	1954	339	389	528	136	2157	3148	1"
1000	4	240	440	699	2160	339	389	528	136	2300	3579	1"
1100	4	240	440	730	2310	339	389	528	136	2513	3779	1 1/2"
1200	4	254	480	775	2551	336	389	659	170	2589	3807	1 1/2"
1300	4	254	480	805	2882	336	389	659	170	3120	4482	1 1/2"
1400	4	279	520	875	3250	336	389	659	170	3525	4952	1 1/2"
1500	4	279	520	925	3695	336	389	659	170	3975	5464	1 1/2"

HYDRAULIC ACTUATOR

The definition variables are as follows:

B = Max. width of the valve (without actuator).

P = Max. height of the valve (without actuator).

The hydraulic actuator includes:

- Hydraulic cylinder
- Yoke

Options:

- Available: ND 50 a ND 1400
- Different types and brands available according to customer's requirements.
- Other pressures on request (ΔP).

ND	ΔP (bar)	A	B	C	P	Hh	Ø CIL.	Ø VAST	S (B.S.P.)	Oil (dm ³)	r (B.S.P.)
50	10	54	109	106	280	482	25	18	3/8"	0,04	1/4"
65	10	54	109	113	306	524	25	18	3/8"	0,05	1/4"
80	10	57	109	122	332	566	25	18	3/8"	0,05	1/4"
100	10	57	109	136	368	615	32	22	3/8"	0,11	1/4"
125	10	64	126	153	421	702	40	28	3/8"	0,19	1/4"
150	10	64	126	168	466	789	50	28	3/8"	0,36	1/4"
200	10	76	126	199	565	958	50	28	3/8"	0,47	3/8"
250	10	76	197	234	626	1100	63	36	3/8"	0,91	1/2"
300	10	83	197	272	739	1272	80	36	3/8"	1,73	1/2"
350	10	83	350	297	842	1441	100	45	1/2"	3,1	1/2"
400	10	96	350	330	933	1613	125	56	1/2"	5,55	3/4"
450	10	96	350	355	1019	1766	125	56	1/2"	6,22	3/4"
500	10	121	380	391	1156	1939	125	56	1/2"	6,99	3/4"
600	10	121	400	461	1338	2273	160	70	1/2"	12,57	1"
700	6	182	400	534	1530	2410	160	70	1/2"	14,58	1"
750	6	188	400	559	1637	2576	160	70	1/2"	15,58	1"
800	6	206	400	584	1733	2742	160	70	1/2"	16,69	1"
900	6	225	400	649	1954	3053	200	90	1/2"	29,22	1"
1000	4	240	440	699	2160	3322	160	70	1/2"	20,81	1"
1100	4	240	440	730	2310	3685	200	90	1/2"	35,66	1" 1/2"
1200	4	254	480	775	2551	3919	200	90	1/2"	38,96	1" 1/2"
1300	4	254	480	805	2882	4565	200	90	1/2"	42,1	1" 1/2"
1400	4	279	520	875	3250	5035	220	90	1/2"	55,12	1" 1/2"